



Residential Fence Permit Application

Morgan City Corporation • 90 W. Young Street, Morgan, UT 84050 • Phone: (801) 829-3461 • Fax (801) 829-6684

PROPERTY OWNER INFORMATION

Name:	Phone:
Address:	Date:

FENCE LOCATION & INFORMATION

Please see the fence Ordinance for more specific requirements, especially regarding corner lots and utilities.

☐ Wood ☐ plastic/vinyl ☐ Chain Link ☐ Specify Other:

As a general rule, the maximum fence height allowed in the front yard setback is 3 feet. The maximum fence height allowed behind the front yard setback is 6 feet. Fencing must be held back a minimum of 1 foot behind the sidewalk. Utility meters may not be fenced into the rear yard area. Utility structures like transformers, other electrical boxes, phone pedestals, fire hydrants, etc., generally require a 3' setback from fencing. There is certain electrical equipment that requires more clearance. Please contact the power department before fencing around any of their equipment @ 801-791-3124.

PROPERTY DIAGRAM

Please use the space below to draw a diagram of the owner's property, indicating the proposed fence location and height. Include the location of the streets, driveways, gas and electric meters (typically on the house), and existing utility structures. Please include dimensions.

Applicant Name:	Applicant Signature:	Phone:
-----------------	----------------------	--------

OFFICE USE ONLY

Date Filed:	Fees Paid: N/A	Received By:
<input type="checkbox"/> Approved <input type="checkbox"/> Denied	Administrator Signature:	Date Signed:

MORGAN CITY FENCE REGULATIONS

All fencing must be at least 1' behind the sidewalk

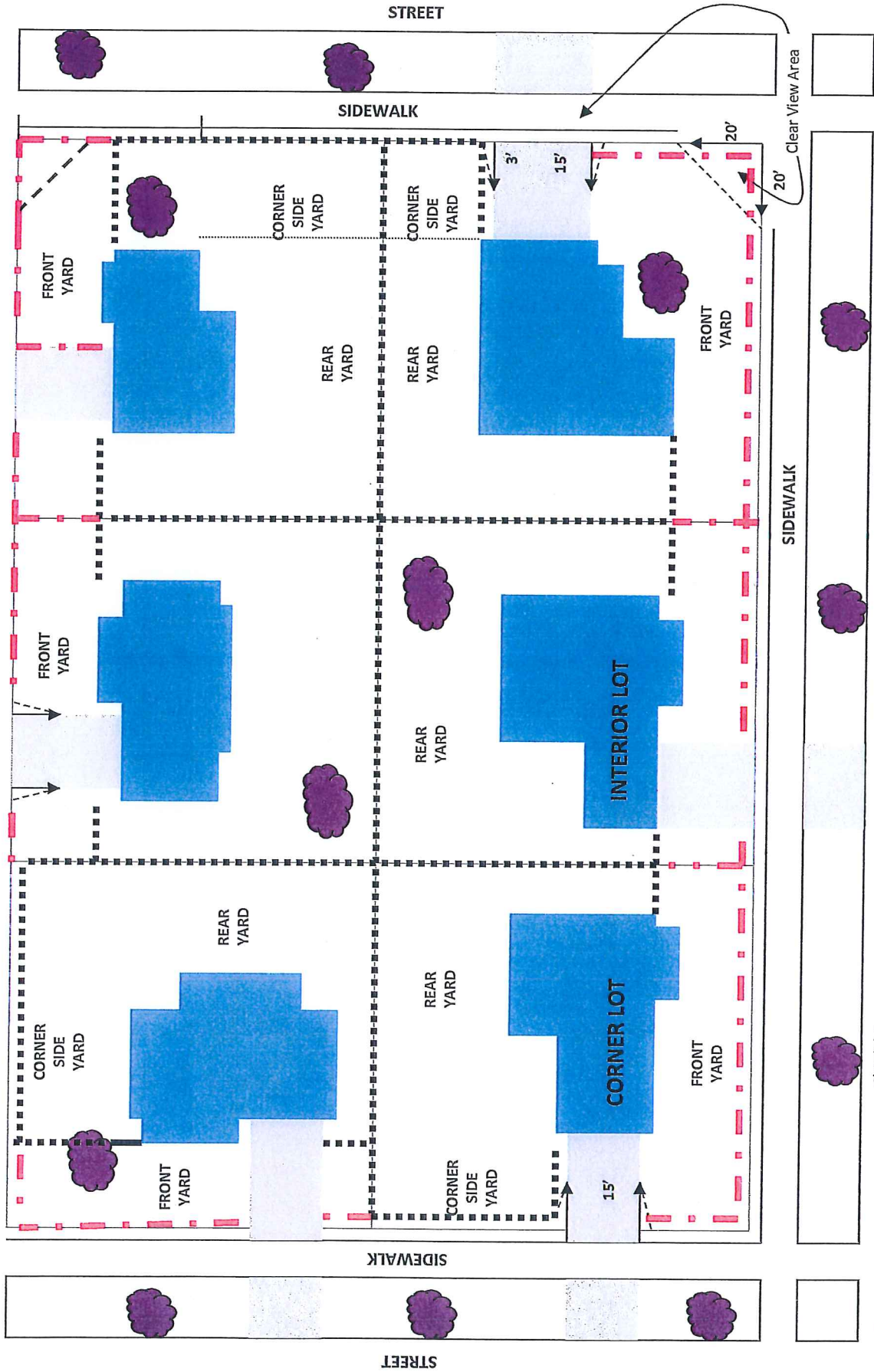

10-10-8: SCREENING, FENCE REQUIREMENTS; PERMIT CLEAR VIEW:

A. Clear View Areas Generally: It is unlawful to place any obstruction within the clear view area, except as provided herein. The clear view areas are as follows:

1. Driveways: The clear view areas for driveways is that triangular area bounded by lines drawn from a point on each edge of the driveway set back fifteen feet (15') from the front property line, to points at the property line in front of the property, thirty feet (30') either side of each edge of the driveway for all streets, excepting 700 East and State Streets, which shall be forty feet (40'). For purposes of this section, the "edge of driveway" shall mean from the point of the driveway that is perpendicular to the street right of way, excluding any driveway expansion that is behind a sidewalk location that does not affect the width of the driveway approach or apron. (Ord. 16-07, 6-14-2016)
2. Corner Lots: The clear view area for corner lots is:
 - a. Where curbs are installed, the clear view area shall include that portion of the corner lot lying within a triangular area formed by a diagonal line connecting lines located at the top back of the curbs extending from the intersection forty feet (40').
 - b. Where no curb exists, the clear view area shall include that portion of the corner lot lying within a triangular area formed by a diagonal line connecting lines located at the property/right of way line twenty feet (20') from the intersection of said property/right of way line.
3. Double Frontage Corner Lots: Where the double fronted lot is also a corner lot (3 frontages), the clear view area across corner property required shall be enforced at street intersections at both front and rear of the lot.

B. Plantings, Generally: For purposes of this section hedges or similar plantings will be treated as a fence.

1. Shade trees or other plantings which project over any sidewalk shall be pruned clear of all branches between the ground and a height of seven feet (7') for that portion of the plant located over the sidewalk. Shade trees and plantings which project over any street or access road which may be used for emergency purposes, shall be trimmed to a height of thirteen feet six inches (13'6") from the grade of the street or access road.
2. Shrubby, bushes, or other plantings within the park strip or other portions of the right of way, shall be trimmed so that they do not exceed the height of three feet (3'). (Ord. 13-06, 6-25-2013)

C. Plantings Within Clear View Areas: All plantings of trees, shrubs, or bushes shall be trimmed or pruned so that the shrubs or bushes do not exceed the height of three feet (3') above street level and so that trees are pruned clear of all branches between the ground and a height of seven feet (7'). These measurements are to be made from the top of back of curb, or where no curb exists, from the existing grade at the right of way line.

D. Fencing, Generally: No fence shall exceed six feet (6') in height without planning commission approval. No fence shall exist over eight feet (8') without an engineer's approval. No fencing shall be installed closer than one foot (1') from a public sidewalk. Where no sidewalk exists, no fencing shall be installed closer than one foot (1') from the right of way line. Fencing must be installed so as not to interfere with public utilities. Fencing must not be installed closer than two feet (2') from a water meter vault, and five feet (5') from a power pole, and two feet (2') from power meters.

1. Permit: Prior to the installation or construction of fencing on residentially zoned, residentially used, or commercial property, an application must be submitted to the city for review. If the application is found to be in compliance with this code, a permit will be issued. Upon receiving a permit, the fence may be installed. The issued permit must be retained on the premises for which the permit was issued until the fence is constructed and inspected for compliance with this section by a representative of the city.
2. Review: If the subject lot is of such a shape or configuration, or possesses other topographical conditions not contemplated by this section, it may be reviewed by the building official to determine whether the proposed fencing meets the intent of this section. If the applicant does not agree with the resolution proposed by the building official, the application will be reviewed by the planning commission. The commission's review is to determine whether the application meets the intent of this section. Any appeal from the commission is to the land use appeal authority. The land use appeal authority shall determine whether there is substantial evidence to support the commission's decision. Any conflict between this section and the clear view provisions shall be resolved in favor of the more strict provision.
3. Material: Fencing shall be made of a durable material such as chainlink, wood, vinyl, wrought iron, etc. Materials commonly used for temporary purposes, such as plastic, or material used for agricultural purposes, such as field fencing or barbed wire, shall not be used. Barbed wire and other field type fencing may be used in areas where zoning allows farm animals, if used for the purpose of keeping animals contained.
4. Front Yard: Fencing not exceeding three feet (3') in height is allowed in front yards.

Exception: When a taller fence from a side yard or street side yard is transitioning to a front yard fence, this transition may be tapered down within the first ten feet (10') of the taller fence.

5. Side Yards, Street Side Yards, And Rear Yards: Fencing not exceeding six feet (6') in height is allowed in side yards, street side yards and rear yards.

Exception: If the driveway to the main building is in the street side yard, fencing from the driveway edge, closest to the rear lot line, extending to the front, shall not exceed three feet (3') in height. (Ord. 16-07, 6-14-2016)

- E. Signs: If a sign is permitted in the zoning district, it may be located in the clear view area where only the minimum necessary supports are visible to a height of not less than ten feet (10'). (Ord. 13-06, 6-25-2013)